

CT & CL Series

AGM VRLA LONG LIFE BATTERIES

12 Volt Front Terminal Series, 50 Ah to 180 Ah (CT)

2 Volt Series, 100 Ah to 3000 Ah (CL)



Features

Maintenance Free Valve Regulated, Absorbed Glass Mat Lead Acid Design

Up to 15 Year Design Life (Under Float Conditions @ 25° C)

Manufactured under a certified ISO9001 quality system

Meets IATA A67 Air Freight specification



YHI

CT SERIES BATTERIES

15 Years Design Life 12 Volt Batteries

Features

- Designed to fit into 19 inch and 23 inch racks.
- Front terminal connection enables easy installation and maintenance.
- Lead Calcium tin alloy grid provides high power density.
- Available in both standard and flame retardant ABS containers.
- May be mounted in any position (except inverted).
- Conform to YD / T799-2002: Valve Regulated Lead Acid Battery For Telecommunications.

Applications:

- Communications
- Control Equipment
- Electricity Utilities
- UPS



General Specifications

Battery Model No.	Nominal Voltage (Volts)	Nominal Capacity @ 10 Hr (Ah)	Length mm	Width mm	Container Height mm	Total Height mm	Weight Kg	Terminal Type	Short Circuit Current (Amps)	Recommended Charging
CT12-50X	12	50	277	106	222	229	17.3	F11	1250	
CT12-80X	12	80	564	115	189	189	28.2	F19	1500	Standby Use :
CT12-100X	12	100	508	110	223	238	32.0	F18	1700	13.6 – 13.8
CT12-105X	12	105	395	110	286	293	35.0	F12	2100	V / unit @25 ° C
CT12-125X	12	125	436	108	317	317	41.0	F15	2250	
CT12-140X	12	140	552	110	288	295	49.0	F12	2500	Temp.Coeff.
CT12-180X	12	180	546	125	317	323	60.0	F15	2700	-20mV/Unit /°C

Terminal Type

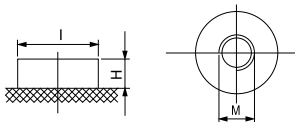

TYPE	F11	F12	F15	F18	F19
M	6	8	8	6	8
I	14	16	19	20	*
H	2	2	2	3	*

*Refer terminal detail F19

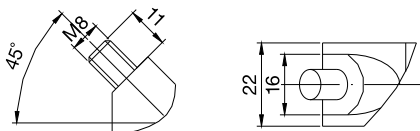

CT SERIES PERFORMANCE DATA @ 25° C

Constant Power Discharge (Watts / Cell)

End Voltage 1.70 Vpc

Model Number	10 Mins	15 Mins	20 Mins	30 Mins	45 Mins	1 Hour	2 Hours	3 Hours	4 Hours	5 Hours
CT12-50X	168	143	122	102	79.8	65.3	37.9	28.0	21.8	18.2
CT12-80X	269	230	197	164	128	104	60.7	44.8	35.0	29.2
CT12-100X	337	286	245	205	160	131	75.9	56.0	43.8	36.5
CT12-105X	354	301	258	215	168	137	79.7	58.7	46.0	38.3
CT12-125X	406	347	293	239	184	150	87.9	64.7	51.5	43.6
CT12-140X	441	377	317	258	200	165	97.5	73.3	58.1	49.0
CT12-180X	541	480	409	339	262	217	130	96.0	75.4	63.1

End Voltage 1.75 Vpc

Model Number	10 Mins	15 Mins	20 Mins	30 Mins	45 Mins	1 Hour	2 Hours	3 Hours	4 Hours	5 Hours
CT12-50X	158	135	116	97.9	76.9	63.5	37.5	27.7	21.7	18.1
CT12-80X	252	216	186	156	123	102	60.0	44.3	34.7	29.0
CT12-100X	316	270	233	196	154	127	75.0	55.4	43.4	36.2
CT12-105X	331	284	245	206	162	133	78.7	58.2	45.5	38.0
CT12-125X	383	333	282	232	179	147	86.4	63.9	51.0	43.2
CT12-140X	418	358	304	250	194	162	96.3	72.3	57.4	48.5
CT12-180X	517	458	393	328	257	212	127	95.0	74.7	62.5

End Voltage 1.80 Vpc

Model Number	10 Mins	15 Mins	20 Mins	30 Mins	45 Mins	1 Hour	2 Hours	3 Hours	4 Hours	5 Hours
CT12-50X	147	127	110	93.4	74.1	61.7	37.0	27.5	21.5	17.9
CT12-80X	235	203	176	150	119	98.8	59.3	44.0	34.4	28.7
CT12-100X	294	254	220	187	148	123	74.1	54.9	43.0	35.9
CT12-105X	309	267	231	196	156	130	77.8	57.7	45.2	37.7
CT12-125X	361	318	271	225	175	144	85.0	63.2	50.5	42.9
CT12-140X	395	340	291	242	189	159	95.0	71.3	56.7	48.0
CT12-180X	492	435	376	318	251	208	125	94.0	74.0	62.0

Constant Current Discharge (Amps)

End Voltage 1.80 Vpc

Model Number	10 Mins	15 Mins	20 Mins	30 Mins	45 Mins	1 Hour	2 Hours	3 Hours	5 Hours	10 Hours
CT12-50X	77.0	66.0	57.5	49.0	38.8	32.4	18.3	13.6	9.0	5.0
CT12-80X	122	105	91.5	78.1	62.1	51.8	29.3	21.8	14.4	8.0
CT12-100X	153	132	115	98.0	77.6	64.7	36.7	27.3	18.0	10.0
CT12-105X	161	139	121	104	81.5	67.9	38.5	28.7	18.9	10.5
CT12-125X	183	165	144	123	95.0	80.0	45.5	34.0	22.8	12.5
CT12-140X	203	185	161	137	106	87.0	50.3	38.0	26.0	14.0
CT12-180X	261	238	207	176	135	109	63.3	48.0	32.1	18.0

CL SERIES BATTERIES

15 Years Design Life 2 Volt Batteries

Features

Wide range of capacities – 100 Ah up to 3000 Ah

Proven reliability

Conform to JB/T8451-1996 : Specification for order of Valve Regulated Sealed Lead Acid Batteries

Applications:

Telecommunications

Electricity Generation & Utilities

Control Systems

Emergency Lighting

UPS

Shallow cycling applications



General Specifications

Battery Model No.	Nominal Voltage (Volts)	Nominal Capacity @ 10 Hr (Ah)	Length mm	Width mm	Container Height mm	Total Height mm	Weight Kg	Terminal Type	Short Circuit Current (Amps)	Recommended Charging
CL100	2	100	171	72	206	211	7.2	F10	3780	
CL150	2	150	172	102	205	227	8.2	F10	4100	Standby Use :
CL200	2	200	173	111	330	364	15.0	F10	4250	
CL300	2	300	171	151	330	364	21.0	F10	6180	2.25 – 2.30
CL400	2	400	210	176	330	367	28.0	F10	8000	V/ cell @ 25 ° C
CL500	2	500	241	175	330	365	33.0	F10	9800	
CL600	2	600	302	175	330	367	42.0	F10	11500	Temp. Coeff.
CL800	2	800	410	175	330	367	57.0	F10	15600	-3.3mV / Cell / ° C
CL1000	2	1000	475	175	330	367	66.5	F10	17600	
CL1500	2	1500	400	350	345	382	100.0	F10	23500	
CL2000	2	2000	490	350	345	382	132.0	F10	29800	
CL3000	2	3000	710	350	345	382	204.0	F10	38500	

Terminal Type

F10

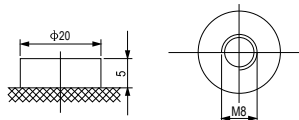

YHI POWER PTY LTD (Australia)

Head Office (Australia)

1044 – 1046 Canley Vale Road,
Wetherill Park, NSW 2164

Ph: (02) 8787 9218

Fax: (02) 9756 4066

Email: sales@yhipower.com.au

Website: www.yhipower.com.au

Melbourne Office Ph: 0413 381 228

Brisbane Office Ph: 0422 000 276

YHI (New Zealand) Ltd

PO Box 97 - 116

South Auckland Mail Centre

Ph: (09) 262 4210

Fax: (09) 262 4211

Email: powersales@yhi.co.nz

